

Memorandum

To: Programs, Projects, and Operations Subcommittee

From: Eric Williams, Natural Resources Planner

Date: February 6, 2025

RE: Contract Amendment 5 with Ehrhart, Griffin & Associates for Beltline Trail

The District signed an Interlocal Agreement with the City of Omaha for design and construction of the Beltline Trail in the area from Hamilton Street at Military Ave, to the Metro transit center north of 31st and Sprague Street. In March 2021, the District contracted with a design team led by Ehrhart Griffin and Associates (EGA) to develop a conceptual plan for the entire corridor, and to identify multiple phases of the project which can be constructed independently. This process allows the District to deliver benefits to residents in our community in a timely fashion. Construction for Phase 1 was completed in 2022, and Phase 2 in 2023. Phase 3A is currently under construction, and Phase 4 will be under construction in the summer of 2025. Minor contract Amendments 3, and 4 were within management authority and were previously approved.

Land rights for the length of trail from Hamilton Street to Grant Street were held by several different property owners. Acquisition of larger parcels between Hamilton and Decatur was completed in 2024, while smaller parcels from Decatur to Grant are still in process. Dividing Phase 3 into an A and B bid document package allowed Phase 3A to move to bidding and construction without waiting for the additional year anticipated for the additional property rights to the north. This division of plans required some additional professional services that were not included in the original scope.

Following completion of the design for Phase 3A, specific information about unused land along the trail corridor is now finalized. Preliminary work to determine how this adjacent land can be put to the most beneficial community use requires additional discussion with the City of Omaha Planning Department about platting, and additional professional services.

The recommended amendment to the professional services agreement related to Phase 3A, Phase 3B represents an increase of \$46,780 to the total contract amount.

- **Management recommends that the Subcommittee recommend to the Board of Directors that the General Manager be authorized to execute the proposed Amendment No. 5 to the Professional Services Agreement between the District and Ehrhart Griffin & Associates for the Beltline Trail Project for the maximum amount of \$46,780 bringing the total maximum not to exceed contract amount to \$905,914.54, subject to changes deemed necessary by the General Manager and approval as to form by District Legal Counsel.**

EXHIBIT A

PROJECT NO. SHEET NO.
EGA21102B 12
QPW-54638 PD



SCALE 1" = 100'

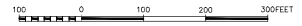

LEGEND

- PROPERTY LINE
- EDGE OF TRAIL SHOULDER
- - - TRAIL CENTERLINE

PHASE
3A

PHASE
3B

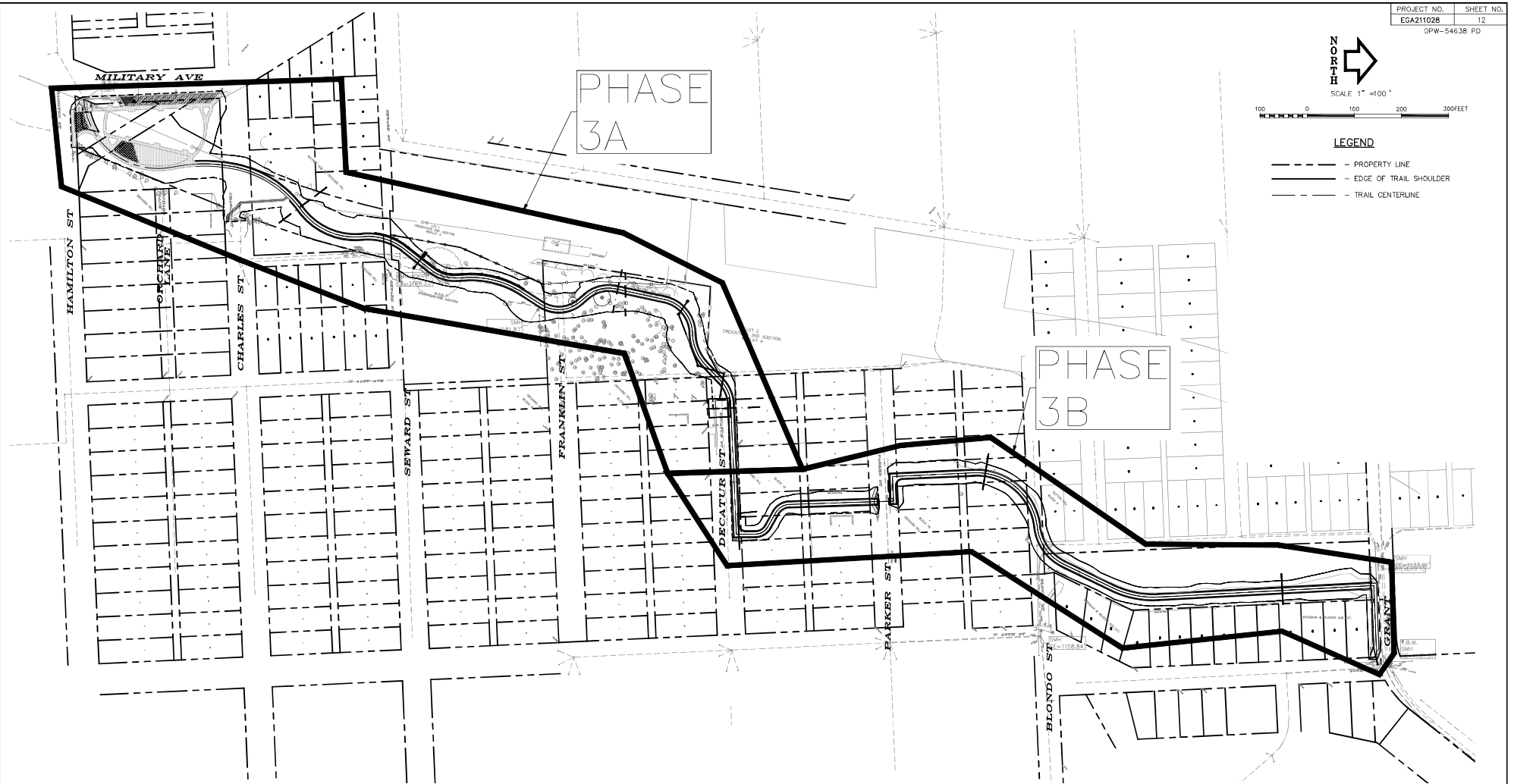

OVERALL SITE PLAN
PHASE 3 SPLIT



NOTE:
UNDERGROUND UTILITY LOCATIONS SHOWN ARE FROM INFORMATION PROVIDED TO US FROM UTILITY COMPANIES. UTILITY COMPANIES MAKE NO WARRANTIES OR GUARANTEES REGARDING THE ACCURACY OF THE INFORMATION CONTAINED IN THEIR DOCUMENTS AND PROVIDES IT ONLY AS GENERAL INFORMATION TO THE RECEIVER. FOR SPECIFIC LOCATIONS DURING CONSTRUCTION CALL TOWERS HOTLINE: 1-800-331-5869 (STATEWIDE) PRIOR TO DIGGING.

REVISIONS			
NO.	DESCRIPTION	DATE	BY



This is **EXHIBIT K**, consisting of 12 pages, referred to in and part of the **Agreement between Owner and Engineer for Professional Services** dated March 12, 2021.

**AMENDMENT TO OWNER-ENGINEER AGREEMENT
Amendment No. 5**

The Effective Date of this Amendment is: _____.

Background Data

Effective Date of Owner-Engineer Agreement: March 12, 2021

Owner: Papio-Missouri River Natural Resources District

Engineer: Ehrhart Griffin & Associates

Project: Beltline Trail

Nature of Amendment:

- Additional Services to be performed by Engineer
- Modifications to services of Engineer
- Modifications to responsibilities of Owner
- Modifications of payment to Engineer
- Modifications to time(s) for rendering services
- Modifications to other terms and conditions of the Agreement

Description of Modifications:

See attached.

Agreement Summary:

Original agreement amount:	\$ 282,155.00
Net change for prior amendments:	\$ 576,979.54
This amendment amount:	\$ 46,780.00
Adjusted Agreement amount:	\$ 905,914.54

Change in time for services (days or date, as applicable): _____

MODIFIED VERSION of

Exhibit K – Amendment to Owner-Engineer Agreement.

EJCDC® E-500, Agreement Between Owner and Engineer for Professional Services, Copyright © 2014 by the National Society of Professional Engineers, American Council of Engineering Companies, and American Society of Civil Engineers. Those portions of the text that originated in copyrighted EJCDC documents remain subject to the copyright. A redline comparison copy highlighting the modifications will be made available upon request if you have not already received one.

The foregoing Agreement Summary is for reference only and does not alter the terms of the Agreement, including those set forth in Exhibit C.

Owner and Engineer hereby agree to modify the above-referenced Agreement as set forth in this Amendment. All provisions of the Agreement not modified by this or previous Amendments remain in effect.

OWNER:

ENGINEER:

Papio-Missouri River Natural Resources District

By: _____
Name: John Winkler
Title: General Manager

By: Mark Dethlefs
Name: Mark Dethlefs, PE
Title: Project Manager

Date Signed:

Date Signed: February 6, 2025

MODIFIED VERSION of

Exhibit K – Amendment to Owner-Engineer Agreement.

EJCDC® E-500, Agreement Between Owner and Engineer for Professional Services, Copyright © 2014 by the National Society of Professional Engineers, American Council of Engineering Companies, and American Society of Civil Engineers. Those portions of the text that originated in copyrighted EJCDC documents remain subject to the copyright. A redline comparison copy highlighting the modifications will be made available upon request if you have not already received one.



February 6, 2025

John Winkler
Papio-Missouri River Natural Resources District
8901 S 154th Street
Omaha, NE 68138

RE: Omaha Beltline Trail Contract Amendment 5
EGA Project No. 211028

Dear Mr. Winkler,

As discussed between the Papio-Missouri River Natural Resources District and EGA, Phase 3 of the Beltline Trail project is to be split into two separate sub-phases. Additional services are needed to split the construction documents into two separate sets, apply for the additional required permits, and perform construction management services for the additional phase. Also, additional full-time resident construction observation for the end of Decatur Street is required due to the design of the trail as required by the City of Omaha Public Improvement Permit.

Additionally, it was also requested that the parcels of property that the NRD owns for Phase 3a be re-platted so that the surplus property, which is not needed for the proposed trail, is separated from the property that will be transferred to the City of Omaha. Therefore, a contract amendment is necessary to complete this work.

Below highlights these services and fees to be included in the contract amendment:

- **Additional Construction Documents: \$4,500.00**
 - Split the construction plans that were already mostly completed into two separate phases.
 - Adjust the current Phase 3 permits so that they only apply towards Phase 3a.
 - Apply for separate permits for Phase 3b.
 - Prepare separate specifications for Phase 3b.
- **Additional Construction Management Services: \$17,120.00**
 - Services during the bidding phase for Phase 3b.
 - Additional construction observation reports for Phase 3b.
 - Additional full time resident construction observation services for the Public Improvements at the end of Decatur Street in Phase 3a.
 - Additional NPDES Erosion Control inspection reporting for Phase 3b.
 - Pay application review for Phase 3b.
- **Additional Project Management: \$960.00**
 - Internal project management services.
 - Coordinate the split with subconsultants.
- **Platting Services: \$16,000.00**
 - Two Administrative Subdivision Plats, including lot pinning.
 - Four Boundary Surveys.
 - One right-of-way dedication description and exhibit.
 - Pre-Application Meeting and other City of Omaha coordination.

- **RDG Subconsultant Fee: \$7,500.00**
 - Split the construction plans that were already mostly completed into two separate phases.
 - Services during the bidding phase for Phase 3b.
 - Additional construction observation services for Phase 3b.
- **Reimbursable: \$700.00**
 - Grading Permit Fee.
 - Milage.

Total Contract Amendment - \$46,780.00

Our 2024 rate table (Exhibit B) is attached as well.

Please do not hesitate to call with any questions you may have regarding these services. The terms and conditions of our original agreement remain unchanged by this contract amendment.

Sincerely,
EHRHART GRIFFIN & ASSOCIATES

Mark Dethlefs

Mark Dethlefs, PE

EXHIBIT B



STANDARD HOURLY RATE SCHEDULE:

Principal	270.00/hr.
Vice President	270.00/hr.
Sr. Engineering Project Manager	220.00/hr.
Engineering Project Manager	160.00/hr.
Project Engineer	153.00/hr.
Design Engineer II	147.00/hr.
Design Engineer I	142.00/hr.
Engineering Technician II	137.00/hr.
Engineering Technician I	121.00/hr.
Construction Manager	160.00/hr.
Construction Observer II	110.00/hr.
Construction Observer I	100.00/hr.
Survey Department Manager	170.00/hr.
Professional Land Surveyor	153.00/hr.
Survey Technician	137.00/hr.
Survey Crew Aid	70.00/hr.
Survey Crew Chief	153.00/hr.
Survey Crew Chief W/ EDM	305.00/hr.
Survey Crew Chief W/ GPS	305.00/hr.
Survey Crew W/Drone	305.00/hr.
Office Clerical	100.00/hr.
Business Manager	100.00/hr.

REIMBURSABLE EXPENSES:

Federal/Airborne Express	37.00/ea.
Mileage	.63/mi.
Mylar Copy (24" x 36")	9.30/ea.
Mylar Copy (30"x 42")	11.60/ea.
Bond Copy (8½x11)	0.80¢/ea.
Bond Copy (8½x14)	0.90/ea.
Bond Copy (11 x 17)	1.00/ea.
Bond Copy (24 x36)	4.60/ea.
Bond Copy (30 x 42)	6.40/ea.
Color Copy (8½x11)	1.30/ea.
Color Copy (8½x14)	1.50/ea.
Color Copy (11 x 17)	3.60/ ea.
Color Copy (24x36)	6.90/ea.
Color Copy (30x42)	10.50/ea.
Scanning	1.30/sf.